

# ARCX 29'

The ARCX 29 kit is a true geodesic structure and comes as a hemisphere. The 29' diameter offers a floor area of 630 sq. ft and a ceiling height of 13' 9". The 60 easy to assemble precision cut SIP triangles can only go together one way--the right way. Each triangle weighs less than 75# and the building can be assembled without heavy equipment. The kits come complete with all plates and opening lumber, expanding foam w/ gun, SIP caulk, 22 gauge steel splines and fasteners. The kits come with architectural plans and elevations. Engineering stamps can be applied to the drawing set for additional cost.

Many floorplans can be adapted to the 650 sq. ft. floor area. We offer several different entry options and provide openings for 2 doors and 4 window/skylight openings as part of the base kit. More openings can be fabricated at additional cost. This dome can be built on a SIP basement, a crawl space, a slab or a easy to install pier system.

32" or 48" SIP riser kits are available which will allow for full height second level headroom. We have added the option of pre-applied Blazeguard fire resistant finish to the dome triangles.

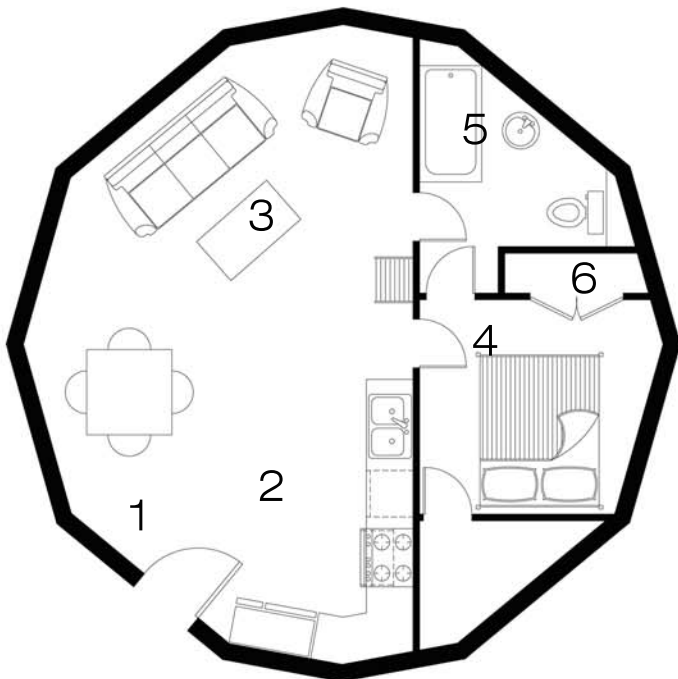
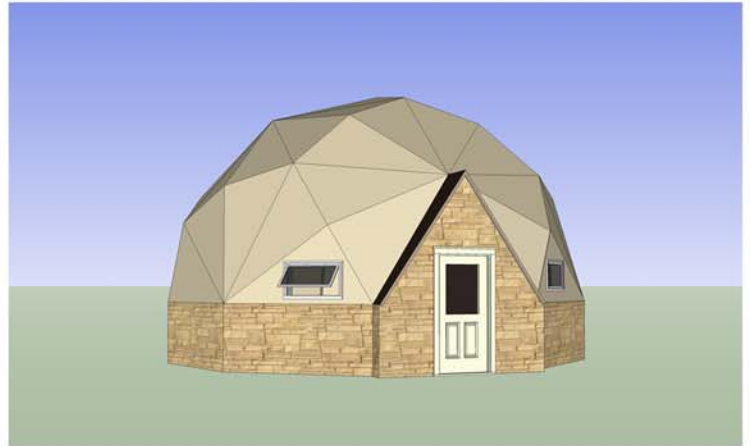

ARCX 29' Base Kit \$10,500

32" Riser Package \$2,178

48" Riser Package \$3,312

Add for Blazeguard \$3,150

\*Packages do not include taxes or shipping

1. Entry
2. Kitchen
3. Living Room
4. Bedroom
5. Bathroom
6. Loft (above bed and bath)